



Stainless Steel Sinks & Accessories

200A80

Address : 5171 Steeles Ave West, Toronto M2N 3G7

Installation Instruction

Single Handle Lavatory Faucet



Before Your Installation

Check to make sure you have the following parts indicated below:

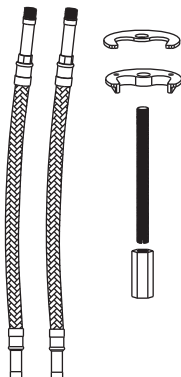
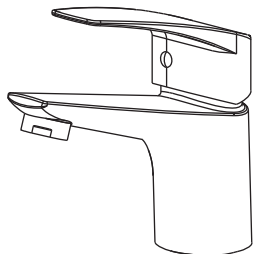

Tools You Will Need



Adjustable wrench



Spanner for aerator
(supplied)

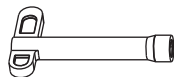

Spanner for body
(supplied)

Replacement Parts

Keep this manual for ordering replacement parts.

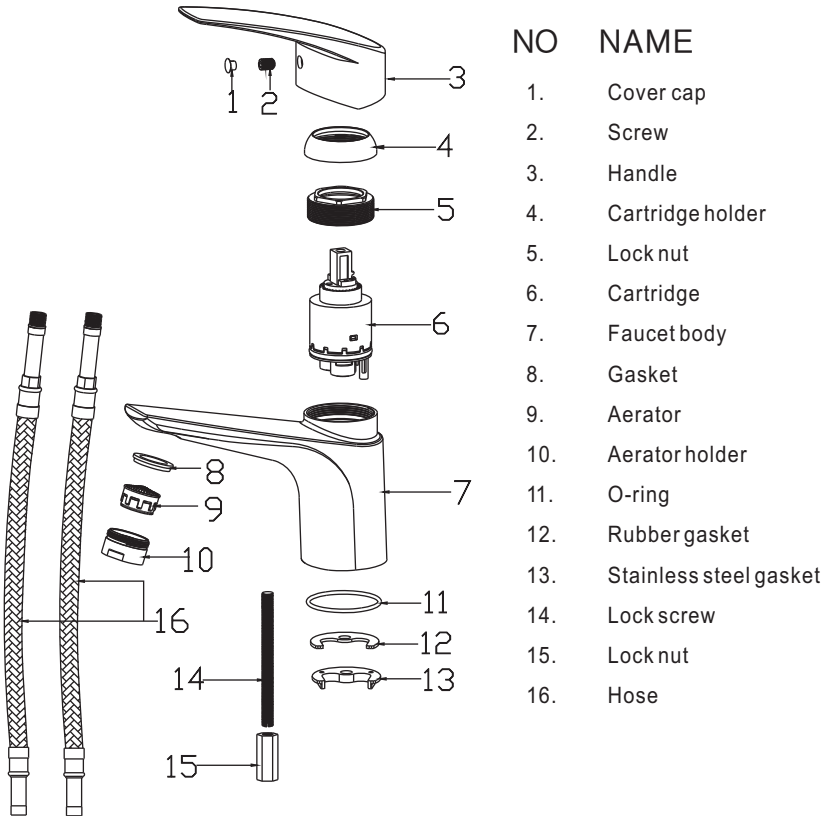

Faucet Installation Procedures

Step ①

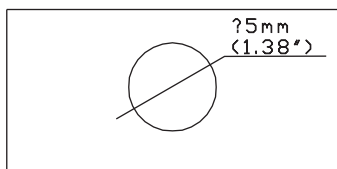
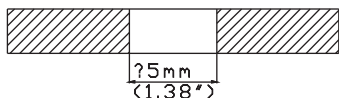

Step ②

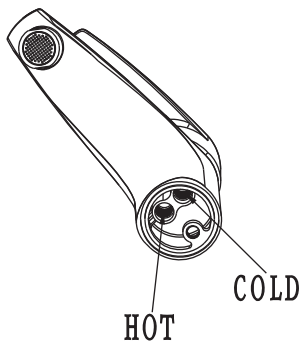

Step ③

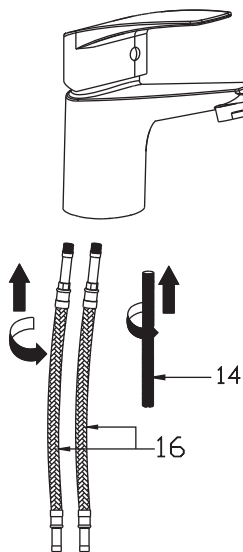

Step ④

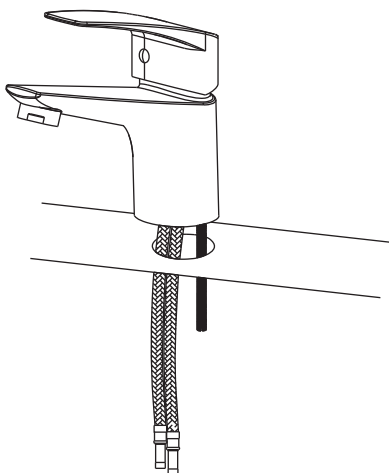

Step ⑤

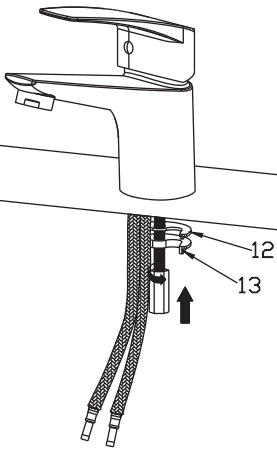

Step ⑥

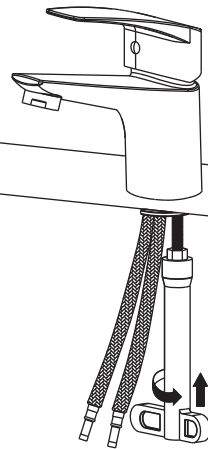

Step ⑦

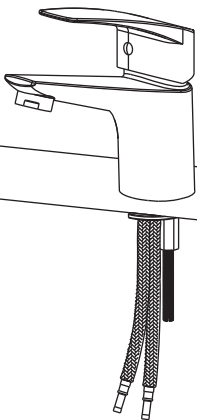

Step ⑧

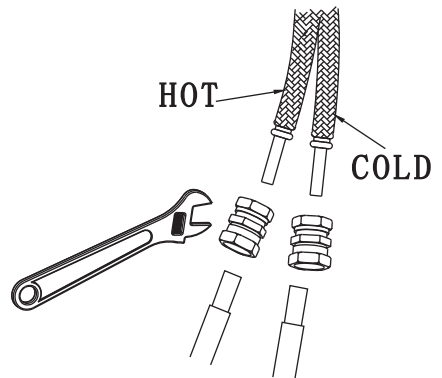

Step ⑨

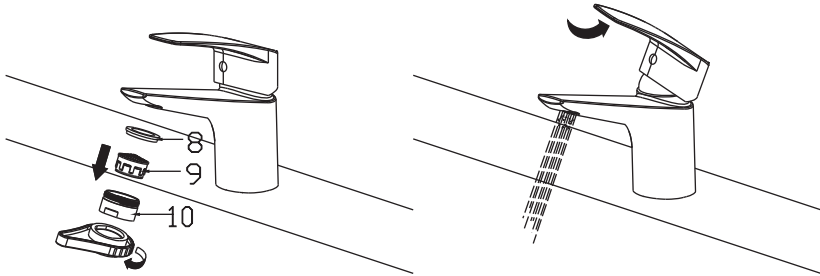

Notice:

Please removing all of the sand, silt and other things from the water hose before assembling, to avoid blocking the faucet and effecting water rate. Please use the special tools to disassemble it and wash with pneumatic equipment, if the faucet blocked.

Step ⑩

